



Hygienic Wall Cladding & Protection Systems
**Antimicrobial technology ensures
exceptional hygiene**

Diamond

- 12 **About Diamond**
- 14 **Illustrated details**
- 15 **Diamond specification**
- 16 **Diamond colours & finishes**

Diamond:

all-round pure protection for demanding environments

Boasting extraordinary strength and resistance to impact, moisture and chemicals, Trovex Diamond is used to effectively clad walls and ceilings, providing a low-maintenance and antimicrobial hygienic surface.

It is the versatility of Trovex Diamond, as well as its impressive attributes, which make it such a successful material. With a range of applications, addressing the most complex requirements, it is thermoformed around corners, married up with stainless-steel surfaces, and used to create ultra-hygienic washstations and doorsets. The tough, long-lasting surface is impervious to impact, spills and stains. Offering exceptional durability, this is an investment that gives returns, year after year.

The complete system includes colour matched trims and weld rod, adhesive and silicone, and is supplied with the option of installation. You can rely on Trovex Diamond, which meets BREEAM requirements.



The Ecosure assurance symbol is a reminder of the eco-friendly properties of Trovex Diamond. As a non-timber product, it has no impact upon the rainforests, and is completely recyclable at the end of its long lifespan. Post-production waste is regenerated into raw material, and the low oil content ensures minimal carbon impact.



Technical profile

Description

Extruded semi rigid PVC sheet, 2.5mm thick with smooth satin finish. Sheets are delivered with a peelable film providing protection throughout installation.

Availability

Standard sheets are 1220mm wide and up to 3000mm long. Other lengths are available to special order. A full range of fixing and joining accessories are available.

Fire Behaviour

Trovex Diamond achieves Class 0 Fire Rating when installed onto a non-combustible substrate, and Class 1 Fire Rating to both BS476 part 7 surface spread of flame and BS476 part 6 for fire propagation.

- › Safe working temperature: 60°C
- › Material softening point: 80°C
- › Flash ignition temperature: 390°C (approx)
- › Set ignition temperature: 450°C (approx)
- › Trovex Diamond is self extinguishing.

Chemical Resistance

Trovex Diamond has a smooth nonporous surface with dimensional stability and excellent chemical resistance. A full chemical resistance chart is available on request.

Maintenance

Regular cleaning with liquid detergent and warm water, using a non-abrasive cloth, will ensure quality of performance. The sheet is resistant to solvent cleaning if necessary. See chemical chart for suitability.

Illustrated details



Thermo-formed internal and external corner

TD01



Two-part joining section

TD02

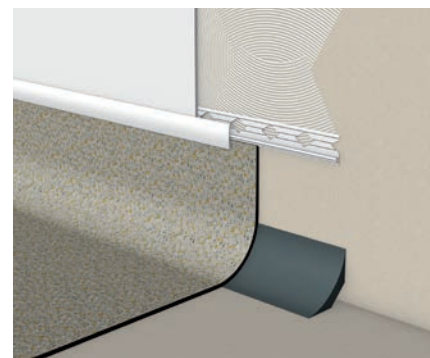

Two-part transition section for vinyl floor and hygienic cladding

TD03

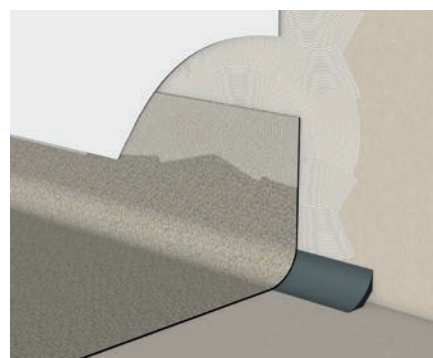

Sheet vinyl floor wetroom

TD04



Edge profile

TD05



External corner

TD06

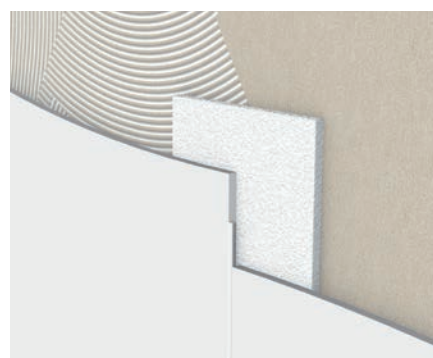

Hot-welded joint

TD07

Diamond specification

K13

Rigid sheet fine linings and panelling

145

PROPRIETARY PLASTICS CLADDING - HYGIENIC WALL CLADDING

Manufacturer

Trovex, Axiom House, Travellers Close, Welham Green, AL9 7JL
Tel: 01707 254 170, Email: sales@trovex.com

Product ref

Trovex Diamond Semi Rigid Hygienic PVC Cladding T10/25/WE (2.5m white), T10/275/WE (2.75m white) or T10/30/WE (3m white).

Substrate

Fair faced blockwork/partition system.

Preparation

Surfaces to be sound and free from contaminants. Dusty or friable surfaces to be stabilised using appropriate stabilising solution. Substrate must be dry - not more than 14% moisture content.

Battens

n/a

Thickness

2.5mm

Width

1220mm

Length

2500mm/3000mm – scribed on site to suit ceiling height.

Colour

Standard Diamond White or selected from the Brilliance, Radiance or Ambience colour collections.

Adhesive

Trovex Bond two-part Urethane Adhesive System / Trovex Bond single component Acrylic Adhesive System.

Primer

As recommended for particular substrates.

Joint treatment

Vertical joints only - Standard two-part colour matched joint profile system, optional colour matched hot welded joint system or colour matched sealant system.

Components / Accessories

Transition profile detail to base of sheet at junction with floor vinyl, edge profile on exposed sheet edges, thermoformed corners to internal and external angles.

Included features

Wetroom junction details where specified on drawings - detail as recommended by manufacturer.

The above specifications represent typical installations. For any other details or specifications, call our technical team on 01707 254 170

Diamond colours & finishes

Designed to achieve a perfectly matched finish, this system offers each of the four key elements - sheet material, trim, jointing weld rod and silicone - in the full range of colours.



Sheet



Trims

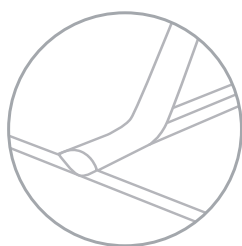

Weld rod



Silicone

Available colours and finishes, see pages 84 - 89 for details:

White Satin

Brilliance High Gloss

Ambience Satin

Resilience Textured

Radiance Satin

Essence Satin

Order colour samples
to check your choices
- it's fast and easy.

Call **01707 254 170**
or visit **trovex.com**
to order samples online.

RAPID
samples

